

A3 Colour Intelligent Devices

# RICOH IM C3000(A) IM C3500(A)

✔ Printer ✔ Copier ✔ Scanner ✔ Fax



Welcome to a new era of technology that keeps your workplace up-to-date, now and in the future. Smarter working made simple thanks to the IM C3000(A)/C3500(A).

**Now is the time to:**

- Protect your devices with easy access to security updates
- Take advantage of easy productivity upgrades at your own pace
- Save costs by bringing high-standard quality print output in-house
- Maximise productivity with streamlined workflows

Today's workplace needs to be ready for tomorrow. Ricoh's intelligent devices provide smooth access to functionality upgrades and productivity enhancements when they are released, without needing to change your hardware. Turn your device into a powerful hub that helps you manage information workflows efficiently, using technology that's scalable, secure, sustainable and simple.

### Get greater control of scan and print management:

- Scan smaller documents with the small size paper scan unit
- Improve scan accuracy – double feed detection unit
- Enhance print management – with EFI controller
- Produce professional grade flyers with inner multi-folding unit

Embrace lower running costs and reduced energy consumption thanks to environmentally friendly low TEC (Typical Electricity Consumption) values. Furthermore, take advantage of RICOH Intelligent Support services that anticipate potential issues and send corrective instructions via the Smart Operation Panel, avoiding interruptions and prolonging the optimal performance of your device – avoiding the need for intervention by more costly IT resources.

Printing from 30 to 35 CPM, the IM C3000(A)/C3500(A) offer next-level productivity. Interact with the 10.1” Smart Operation Panel like a typical smart device and configure it for quick and easy access to apps you use most often. A variety of mobile connectivity options enable printing or scanning to the office network or cloud from a smart device, with built-in support for NFC, AirPrint\* or Mopria. All this underpinned by a unique suite of support apps from RICOH Smart Integration.

### Our intelligent devices offer:

- Efficient working and reduced user intervention – by expanding paper capacity
- Variable finishing and paper options – for a professional touch
- A consistent user experience across your fleet
- Maximum device uptime and minimal disruption with RICOH Intelligent Support

## IM C3000(A) / IM C3500(A) hardware configuration

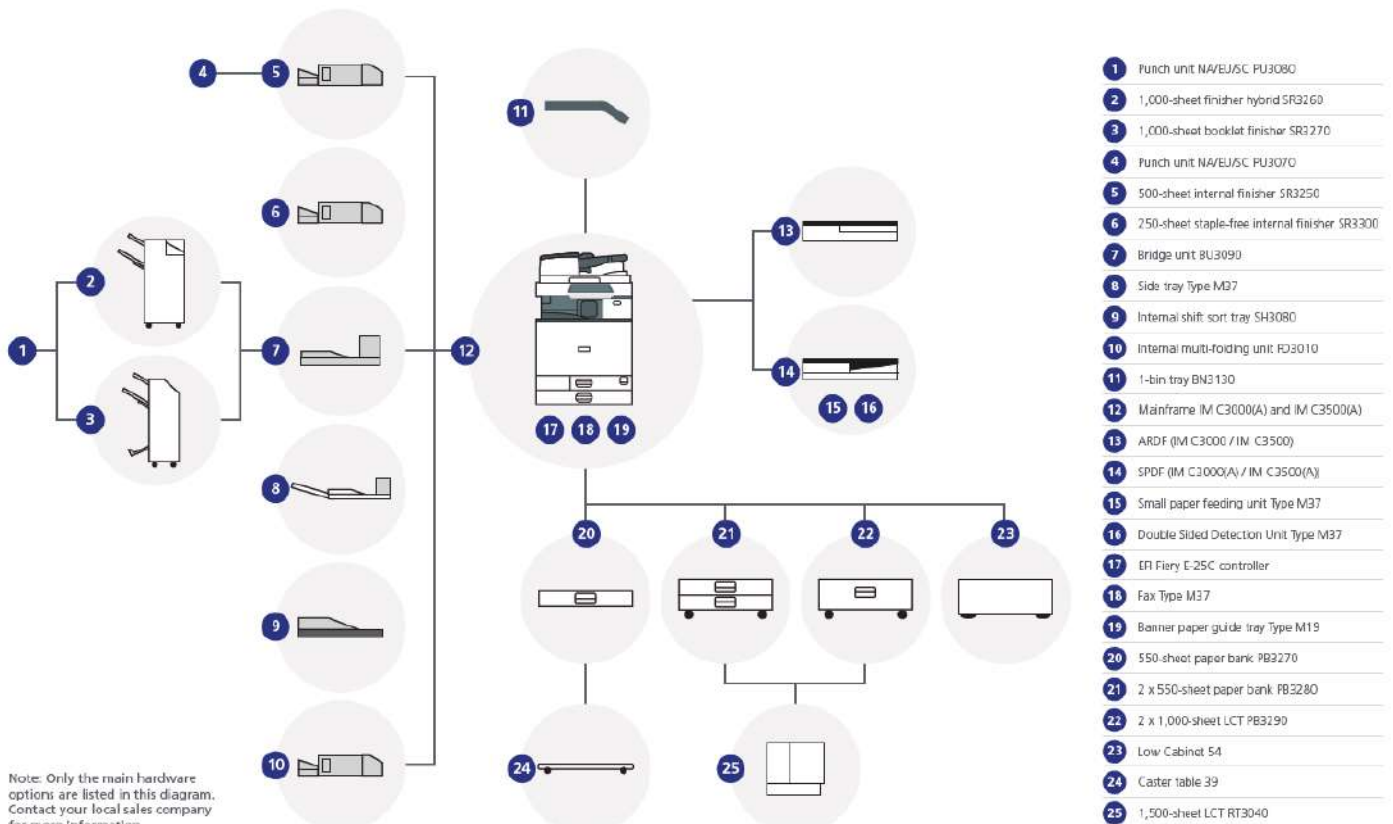

Note: Only the main hardware options are listed in this diagram. Contact your local sales company for more information.

# RICOH IM C3000A/IM C3000/IM C3500A/IM C3500

## MAIN SPECIFICATIONS

	IM C3000	IM C3000A	IM C3500	IM C3500A
<b>GENERAL</b>				
Warm-up time			21 seconds	
First output speed: B/W			4.5 seconds	
First output speed: full colour			6.9 seconds	
Continuous output speed	30 ppm	30 ppm	35 ppm	35 ppm
Memory: standard			2 GB	
Memory: maximum			4 GB	
HDD: standard			320 GB	
HDD: maximum			320 GB	
ARDF capacity			100 sheets	
SPDF capacity			220 sheets	
Weight	99.4 kg	94 kg	99.4 kg	94 kg
Dimensions: W x D x H	587 x 685 x 963 mm	587 x 685 x 913 mm	587 x 685 x 963 mm	587 x 685 x 913 mm
Power source			220 - 240 V, 50/60 Hz	
<b>COPIER</b>				
Multiple copying	Up to 999 copies			
Resolution	600 dpi			
Zoom	From 25% to 400% in 1% steps			
<b>PRINTER</b>				
CPU	ApolloLake E3930 1.3 GHz			
Printer language: standard	PCL5c, PCL6, PostScript 3 (emulation), PDF direct (emulation)			
Printer language: option	Genuine Adobe® PostScript® 3™, PictBridge, PDF Direct from Adobe®			
Print resolution: maximum	1,200 x 1,200 dpi			
Network interface: standard	Ethernet 10 base-T/100 base-TX/1000 base-T, USB Host I/F Type A, USB Device I/F Type B			
Network interface: option	Bi-directional IEEE 1284/ECP, Wireless LAN (IEEE 802.11a/b/g/n), Additional NIC (2nd port)			
Mobile printing capability	Apple AirPrint™, Mopria, Google Cloud Print, NFC, Ricoh Smart Device Connector			
Windows® environments	Windows® 7, Windows® 8.1, Windows® 10, Windows® Server 2008, Windows® Server 2008R2, Windows® Server 2012R2, Windows® Server 2016			
Mac OS environments	Macintosh OS X Native v10.11 or later			
UNIX environments	UNIX Sun® Solaris, HP-UX, SCO OpenServer, RedHat® Linux Enterprise, IBM® AIX			
SAP® environments	SAP® R/3®, SAP® S/4®			
Other supported environments	IBM iSeries			
<b>SCANNER</b>				
Scanning speed: ARDF	80 ipm (200/300 dpi)			
Scanning speed: SPDF	120 ipm (simplex)/240 ipm (duplex)			
Resolution: maximum	1,200 dpi			
Compression method	TIFF (MH, MR, MMR, JBIG2), Grayscale			
File formats	Single Page TIFF, Single page JPEG, Single page High compression PDF, Single page PDF/A, Multi page TIFF, Multi page PDF, Multi page High compression PDF, Multi page PDF/A			
Scan modes	E-mail, Folder, USB, SD Card			
<b>FAX (OPTION)</b>				
Circuit	PSTN, PBX			
Transmission speed	2 seconds			
Modem speed: maximum	33.6 Kbps			
Resolution: standard	8x3.85 line/mm, 200x100 dpi			
Resolution: option	16x15.4 line/mm, 400x400 dpi			
Compression method	MH, MR, MMR, JBIG			
Scanning speed	81 spm	68 spm	81 spm	68 spm
Memory: standard	4 MB, (320 pages)			
Memory: maximum	60 MB, (4,800 pages)			
<b>PAPER HANDLING</b>				
Recommended paper size	Standard paper tray(s):SRA3, A3, A4, A5, A6, B4, B5, B6, Envelopes Optional paper tray(s):SRA3, A3, A4, A5, A6, B4, B5, B6, Envelopes Bypass tray:SRA3, A3, A4, A5, A6, B4, B5, B6, Envelopes, Custom Size paper			
Paper input: standard	1,200 sheets			
Paper input: maximum	4,700 sheets			
Paper output: standard	500 sheets			
Paper output: maximum	1,625 sheets			
Paper weight	Trays: (60 - 300 g/m²), Bypass: (52 - 300 g/m²), Duplex: (52 - 256 g/m²)			
Paper types	Plain paper, Recycle paper, Special paper, Color paper, Letterhead, Cardstock, Preprinted paper, Bond paper, Coated paper, Envelope, Gloss paper, Label paper, OHP			
<b>ECOLOGY</b>				
Power consumption: max.	Less than 1,700 W			
Power consumption operation: B/W	503.3 W	503.3 W	532.9 W	532.9 W
Power consumption operation: Full colour	559.7 W	559.7 W	598.6 W	598.6 W
Power consumption: ready	47.6 W			
Power consumption: sleep	0.55 W			
TEC	1.1 kWh	1.1 kWh	1.3 kWh	1.3 kWh

# RICOH IM C3000A/IM C3000/IM C3500A/IM C3500

## MAIN SPECIFICATIONS

	IM C3000	IM C3000A	IM C3500	IM C3500A
<b>OUTPUT TRAYS AND FINISHER OPTIONS</b>				
2x 550-sheet Paper tray	Paper size: (SRA3, A3, A4, A5, A6, B4, B5, B6), Paper weight: (60-300 g/m <sup>2</sup> )			
1x 550-sheet Paper tray	Paper size: (SRA3, A3, A4, A5, A6, B4, B5, B6), Paper weight: (60-300 g/m <sup>2</sup> )			
2,000-sheet Large capacity tray	Paper size: (A4), Paper weight: (60-300 g/m <sup>2</sup> )			
1,500-sheet side Large capacity tray	Paper size: (A4, B5), Paper weight: (60-300 g/m <sup>2</sup> )			
1,000-sheet Hybrid finisher	Paper size: (SRA3, A3, A4, A5, A6, B4, B5, B6), Paper weight: (52-300 g/m <sup>2</sup> ), 1,000 sheets, Staple capacity: (50 sheets), Staple paper size: (A3, A4, A5, B4, B5), Staple paper weight: (52-105 g/m <sup>2</sup> ), Staple positions: (Top, Bottom, 2 Staples)			
1,000-sheet Booklet finisher	Paper size: (SRA3, A3, A4, A5, A6, B4, B5, B6), Paper weight: (52-300 g/m <sup>2</sup> ), Stack capacity: (1,000 sheets), Staple capacity: (50 sheets), Staple paper size: (A3, A4, A5, B4, B5), Staple paper weight: (52-105 g/m <sup>2</sup> ), Staple positions: (Top, Bottom, 2 staples, Booklet)			
250-sheet Internal finisher	Paper size: (A3, A4, A5, A6, B4, B5), Paper weight: (52-300 g/m <sup>2</sup> ), Stack capacity: (250 sheets), Staple capacity: (5 sheets), Staple paper size: (A3, A4, A5, B4, B5), Staple paper weight: (64-80 g/m <sup>2</sup> ), Staple positions: (Top)			
500-sheet Internal finisher	Paper size: (A3, A4, A5, A6, B4, B5), Paper weight: (52-300 g/m <sup>2</sup> ), Stack capacity: (500 sheets), Staple capacity: (50 sheets), Staple paper size: (A4, A5, B4, B5), Staple paper weight: (52-105 g/m <sup>2</sup> ), Staple positions: (Top, Bottom, 2 staples)			
Internal shift tray	Tray capacity: (250 sheets), Paper size: (SRA3, A3, A4, A5, A6, B4, B5, B6), Paper weight: (52-300 g/m <sup>2</sup> )			
One-bin tray	Tray capacity: (125 sheets), Paper size: (A3, A4, A5, B3, B4), Paper weight: (52-300 g/m <sup>2</sup> )			

### OTHER OPTIONS

Fax unit, G3 Interface, Fax connection unit, Fax memory unit, Cabinet, Caster table, VM card, Memory unit, Side Tray, Banner paper guide tray, Punch units, Internal Multi-fold unit, Camera direct print card, Genuine PostScript 3, IEEE 1284 I/F, IEEE 802.11 a/g/n I/F, Device server unit, File format converter, OCR unit, Enhanced security HDD, Data overwrite security unit, Small paper feeding unit, Page keeper, Imageable area extension unit, ADF handle, External keyboard bracket, Counter I/F unit, Key counter bracket, NFC card reader, Smart card reader built-in unit, EFI controller, EFI Impose, EFI Compose, EFI Hot folders, EFI Spot on

### CONSUMABLES

Toner: black	31,000 prints
Toner: cyan/magenta/yellow	19,000 prints

Consumable yield figures are based on 2p/j 5% coverage on A4

\*Airprint certification will be available in 2019.



### Ricoh UK Ltd.

300 and 800 Pavilion  
Drive Northampton  
Business Park NN4  
7YL Northampton  
United Kingdom



+44(0)1604 814900



www.ricoh.co.uk



Speak to us

T: 0800 046 1332

E: info@insightsystems.co.uk

W: www.insightsystems.co.uk